

Bluetooth compliance:	Bluetooth® version 5.1	Operating temperature:	0 to 45°C
Multipairing:	Maximum 8 phones paired / 1 phone connected at a time	Charging temperature:	10 to 40°C
Operating range:	up to 300 meters (line of sight)	DC input:	5VDC 0.1A
Frequency range:	2.402 - 2.480 GHz	Storage temperature:	-10 to 60°C
Power:	7.09 dBm EIRP	Accessories:	1 USB cable 2 small holders 2 big holders Optional large foam
Battery type:	200 mAh Li-Po		
Charging time:	3 hours (depending on charger)		

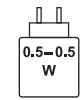

Compatible with any standard USB charger

The power delivered by the charger must be between min 0.5 Watt required by the radio equipment, and max 0.5 Watts in order to achieve the maximum charging speed.

WARNING:



To prevent possible hearing damage,
do not listen at high volume levels for long periods.

CAUTION:

- The disposal of a battery into fire or a hot oven, or mechanically crushing or cutting of a battery, that can result in an explosion.
- Leaving a battery in an extremely high temperature surrounding environment that can result in an explosion or the leakage of flammable liquid or gas.
- A battery subjected to extremely low air pressure that may result in an explosion or the leakage of flammable liquid or gas.

Correct Disposal of This Product (Waste Electrical & Electronic Equipment)

(Applicable in the European Union and other European countries with separate collection systems).

This marking shown on the product or its literature, indicates that it should not be disposed with other household wastes at the end of its working life. To prevent possible harm to the environment or human health from uncontrolled waste disposal, please separate this from other types of wastes and recycle it responsibly to promote the sustainable reuse of material resources. Household users should contact either the retailer where they purchased this product, or their local government office, for details of where and how they can take this item for environmentally safe recycling. Business users should contact their supplier and check the terms and conditions of the purchase contract. This product should not be mixed with other commercial wastes for disposal. This product has an embedded, non-replaceable battery, do not attempt to open the product or remove the battery as this may cause injury and damage the product. Please contact the local recycling facility for removal of the battery. The embedded, non-replaceable battery is designed to last the life time of the product.

**Federal Communications Commission (FCC) Statement
Innovation, Science and Economic Development Canada (ISED) Statement**

15.21
You are cautioned that changes or modifications not expressly approved by the part responsible for compliance could void the user's authority to operate the equipment.

15.105(b)
This equipment has been tested and found to comply with the limits for a Class B digital device, pursuant to part 15 of the FCC/IC rules. These limits are designed to provide reasonable protection against harmful interference in a residential installation. This equipment generates, uses and can radiate radio frequency energy and, if not installed and used in accordance with the instructions, may cause harmful interference to radio communications. However, there is no guarantee that interference will not occur in a particular installation. If this equipment does cause harmful interference to radio or television reception, which can be determined by turning the equipment off and on, the user is encouraged to try to correct the interference by one or more of the following measures :

- Reorient or relocate the receiving antenna.
- Increase the separation between the equipment and receiver.
- Connect the equipment into an outlet on a circuit different from that to which the receiver is connected.
- Consult the dealer or an experienced radio/TV technician for help.

This device complies with part 15 of the FCC rules and Innovation, Science and Economic Development Canada licenceexempt RSS standard(s)
Operation is subject to the following two conditions :
1) This device may not cause interference and
2) This device must accept any interference, including interference that may cause undesired operation of the device.

FCC/ISED RF Radiation Exposure Statement :

This equipment complies with FCC / IC RSS-102 radiation exposure limits set forth for an uncontrolled environment. End users must follow the specific operating instructions for satisfying RF exposure compliance. This transmitter must not be colocated or operating in conjunction with any other antenna or transmitter.



Hereby, EURO COMMUNICATION EQUIPEMENTS declares that the radio equipment type BTBIKE is in compliance with Directive 2014/53/EU.
The full text of the EU declaration of conformity is available at the following internet address:

<http://www.SuperTooth.net/download>

Euro Communication Equipements sas
Route de Foix D117
11 500 NEBIAS
FRANCE



The Bluetooth® word mark and logos are registered trademarks owned by Bluetooth SIG, Inc. and any use of such marks by Euro-CB is under license.
Other trademarks and trade names are those of their respective owners.



MSBIKE-ENV2.3

Aerial - Quick Guide

Aerial is a Bluetooth® hands-free kit for bicycle helmets. With its two small adhesive holders provided, the Aerial can be positioned on any bicycle helmet in a matter of seconds.

Aerial is held securely on its holders by a powerful magnet, making it easy to remove from the helmet if necessary. With its Open Ear Design technology you can communicate safely with your caller. Thanks to the speaker placement above your ears, you experience absolute comfort and remain aware of the surroundings for enhanced safety.

The built-in microphone of the Aerial allows phone conversations or intercom communication between two Aerial devices (second Aerial available as an option).

With its two speakers, you can also listen to your music in stereo, podcasts, and navigation instructions from your smartphone.

The ergonomics and simplicity of the three buttons on the Aerial allow you to keep your phone in your pocket.

INSTALLATION ON HELMET

1. Select the appropriate **Aerial** holders based on the shape of your helmet :
if the surface of the helmet in contact with the holder is too small or not flat enough, choose the large holders.
2. Attach the **Aerial** holder to your helmet, positioning it near your ear in a way that the directive beam-forming microphone points toward your mouth.

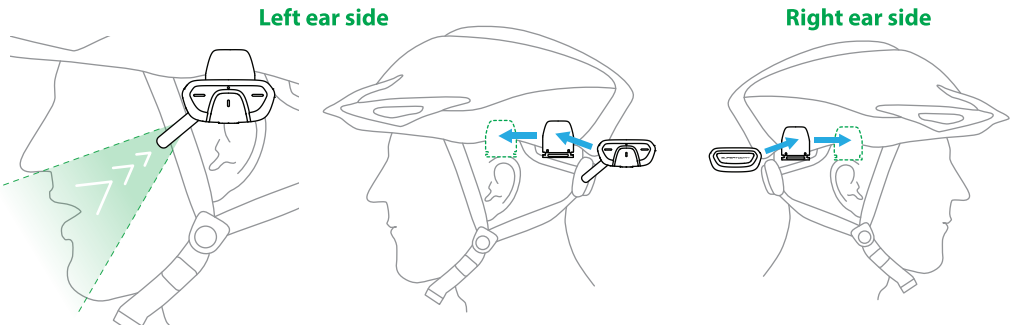

Secure the wire under the helmet foam

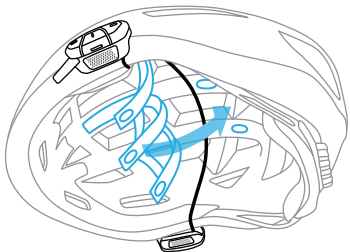

OPTIONAL FOAM (INCLUDED)

- For better wind noise reduction at high speeds or in strong wind conditions, insert the optional foam over the standard foam cover.

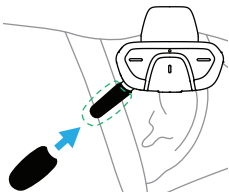

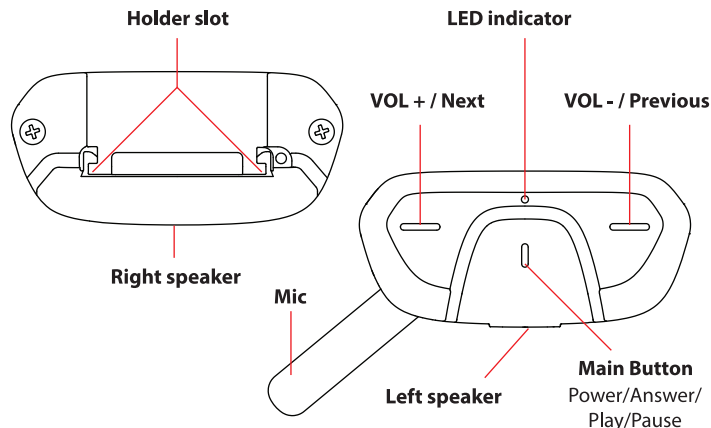

1. PAIRING Aerial TO A BLUETOOTH MOBILE PHONE :

- From OFF, press and hold **Main Button** until LED flashes **red/blue**.
- On your phone, enable Bluetooth function then search for **Aerial R0...**
- When **Aerial** is paired, LED blinks **blue** every 2 seconds.

2. PHONE USE :

- **Answer** : Short press **Main button** to accept the call.
- **End call** : Short press **Main button** to end the call.
- **Reject call** : Long press **Main button** until the first beep.
- **Redial** : Double short press **Main button**.
- **Voice Assistant** : Short press **Main button** to activate (when not in a call).

3. ADJUST VOLUME :

Short press **VOL + / VOL -** to adjust volume. Beep indicates max / min volume.

4. MUSIC STREAMING :

- **Play / Pause** : Press **Main Button** until the 2nd beep (3s).
- **Next / Previous** : Press **VOL + / VOL -** until the first beep.

5. POWER ON/OFF Aerial :

- Press **Main Button** until LED blinks **blue** and ascending tone can be heard.
- Long press **Main Button** until LED blinks **red** and descending tone can be heard.

INTERCOM USE (up to 2 Aerial)

1. PAIRING INTERCOM :

- From OFF, press and hold **Main button** on each unit until LED flashes **red/blue**.
- Then, on **one** of the two units, long press on **VOL + and VOL -** simultaneously (3s) until the 2nd beep.
- When both units are paired, both LED turn **blue** and intercom is connected.

2. DISCONNECT INTERCOM :

Press **Main button** until the **first beep** (1.5s) to disconnect intercom.

3. RECONNECT INTERCOM :

Press **Main button** until the **first beep** (1.5s) to connect intercom.

AUTOMATIC INTERCOM RECONNECTION AND AUTO-POWER OFF FUNCTIONS :

- When intercom connection is lost, each **Aerial** will try to reconnect automatically. After 10 minutes, **Aerial** needs to be reconnected manually.
- If no device is found, the Aerial will automatically switch off after 5 minutes.

4. CHARGING Aerial UNIT :

Connect a USB type-C cable into the charger connector.
The LED will turn **red** while charging.
The LED will turn **green** once the battery is fully charged.

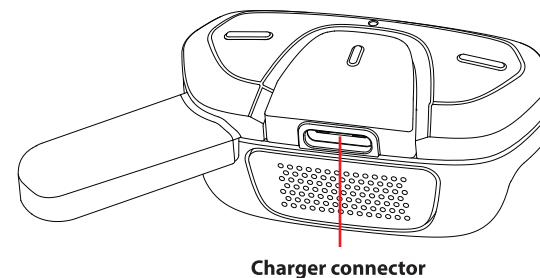

5. RESET AND ERASE PAIRINGS :

- From OFF, long press **all three buttons** at the same time until **Aerial** turns ON and LED will blink **purple** twice and turn off.

(**Note** : All paired devices will be deleted.)